

# Northern Advantage Series

BY: FRIENDSHIP HOMES OF MINNESOTA, INC

## NOTE: OUTSTANDING FRIENDSHIP HOME FEATURES

- \*GLUED AND SCREWED FLOORS
- \*DURABLE WOOD CLOSET SHELVES AND RODS
- \*INTERIOR WALLS ARE SCREWED TO FLOOR AND ROOF TRUSSES
- \*CABINETS BUILT EXCLUSIVELY BY FRIENDSHIP HOMES
- \*MOLDED FIBERGLASS TUBS/SHOWERS
- \*PERIMETER HEAT
- \*36" HIGH COUNTERTOPS THROUGHOUT
- \*TRIPLE SEALED ROOF EDGE
- \*2X6 WALLS WITH R-19 INSULATION
- \*7 1/2' SIDE WALLS
- \*CATHEDRAL CEILINGS THROUGH OUT
- \*WHIRLPOOL GAS RANGE & 16 CF REFRIGERATOR
- \*WATER SHUT OFFS THROUGH OUT
- \*38" FRONT DOOR & 34" 9-LITE REAR DOOR

AND MUCH MORE!!

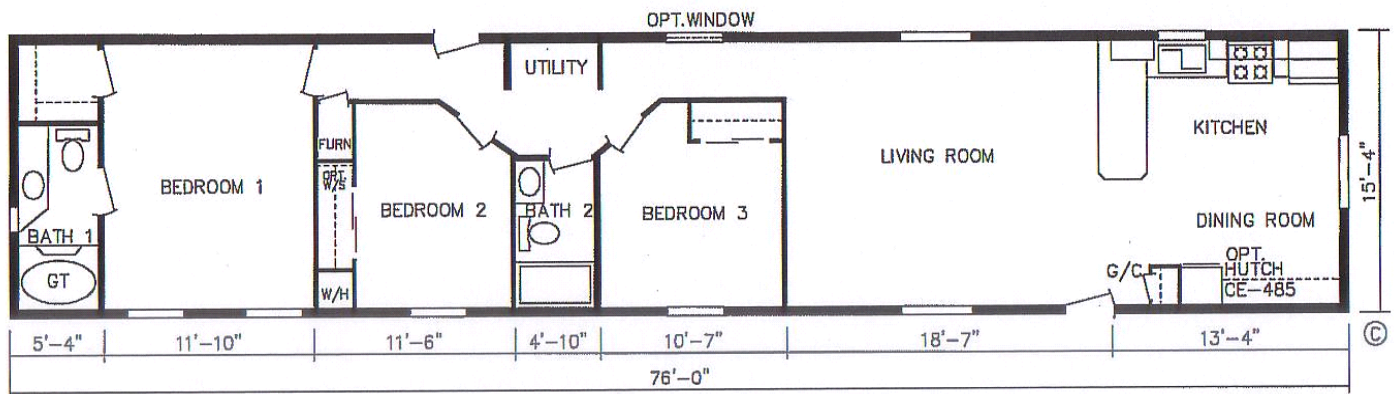
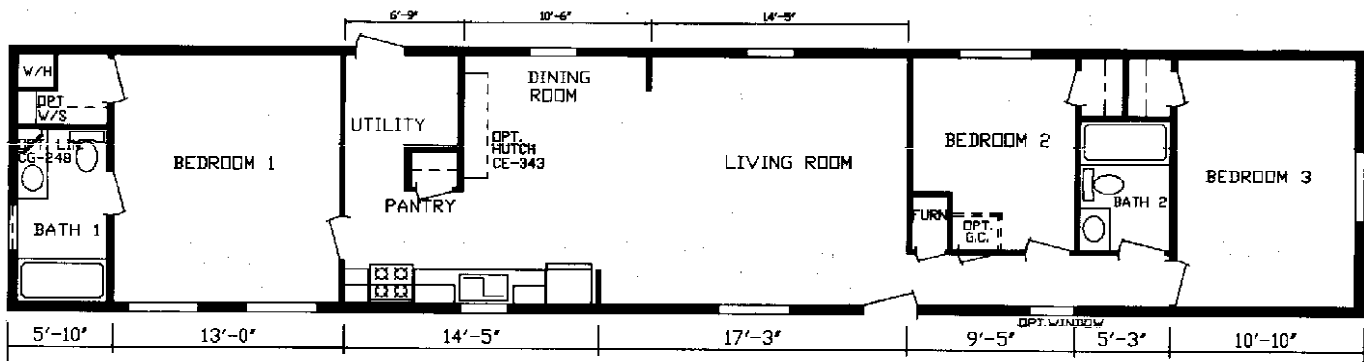

**Starting in the Mid \$40,000's**

**INCLUDES: 18"X42" CONCRETE PIERS, DELIVERY(MAY VARY), SET-UP, SALES TAX, SKIRTING, & CENTRAL AIR**

